

3

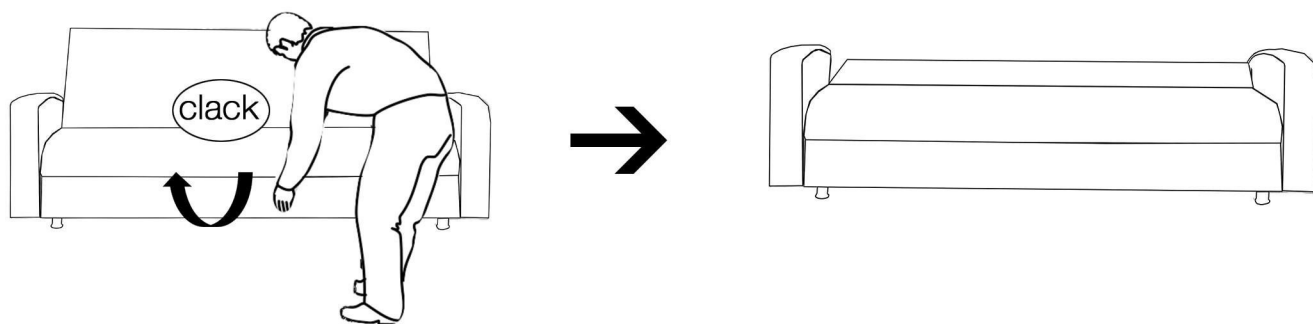

Pentru a folosi canapeaua extinsa, ridicati de sezutul canapelei ca in imaginea de mai sus, pana se aude un clack (ced de al doilea sunet), apoi eliberati usor.

4

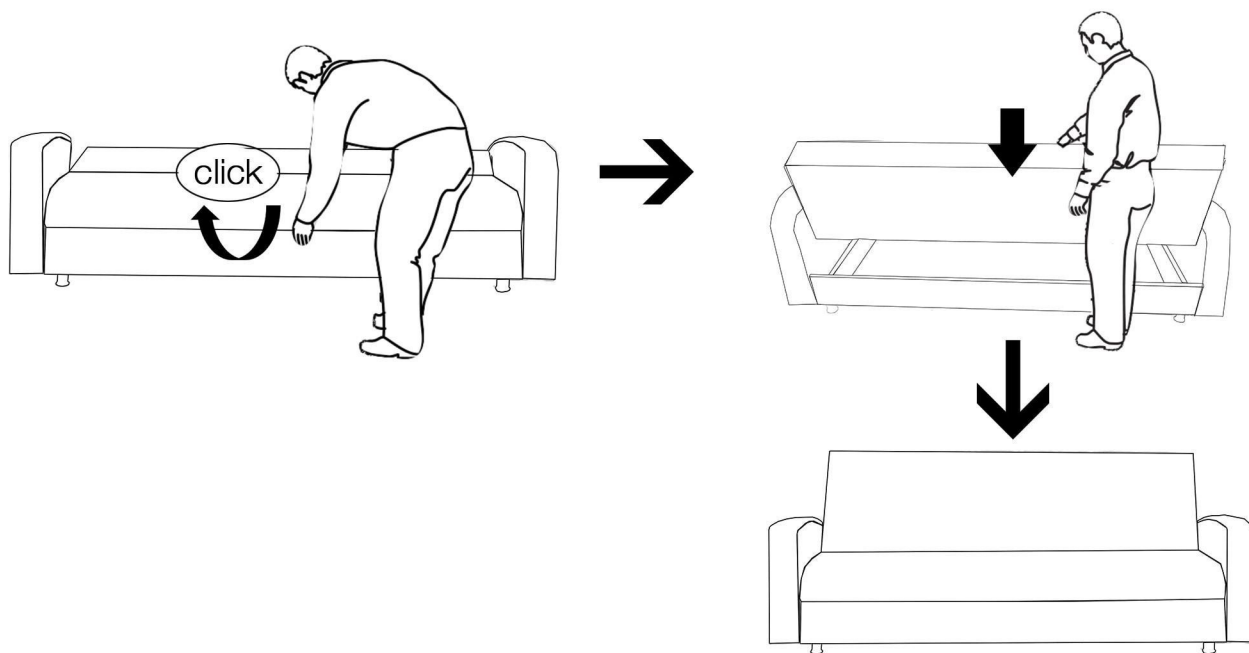

Pentru a reveni la pozitia initiala, ridicati de sezutul canapelei pana se aude un click (primul sunet), apoi apasati pe sezut pana se ajunge in pozitia din imagine.

Instructiuni montaj canapea Amsterdam&Maria

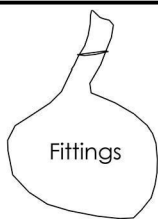
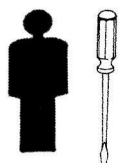

1 piece

6x  A

6x  C

6x  B

4x  D

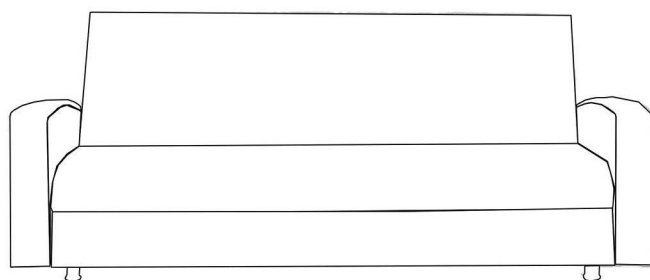

1

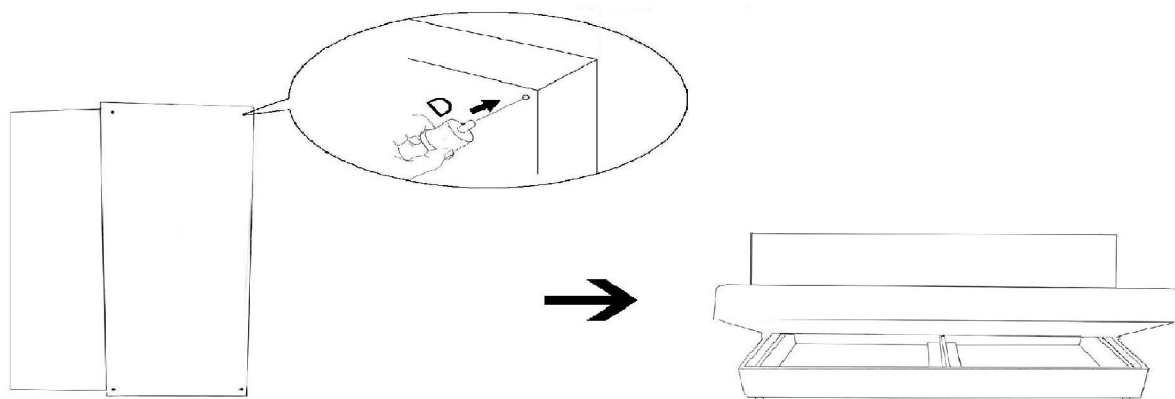

Montati picioarele negre (4xD) prin simpla presare.

2

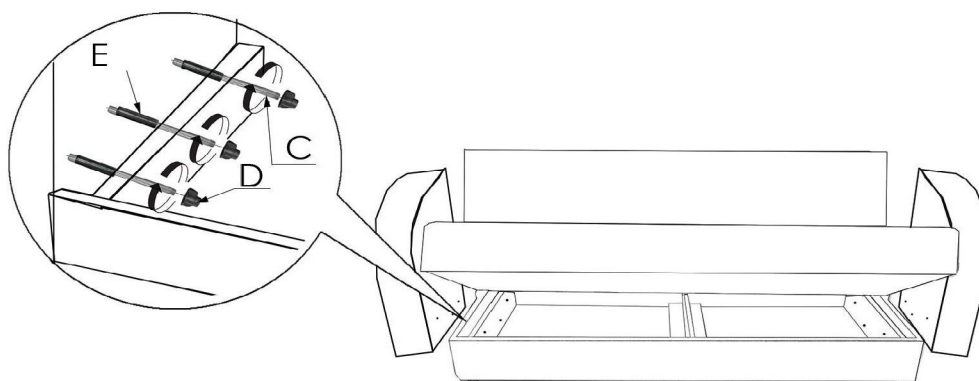

Pentru montajul bratelor, insurubati tijele filetate aproximativ 1 cm in brate, introduceti distantierii negrii intre brat si canapea apoi strangeti fluturii din interiorul canapelei.