

■ Mufa cupru izolata, 0.1 - 6 mm<sup>2</sup>

- Pentru conductoare multifilare fine si extrafine

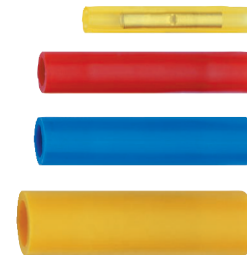
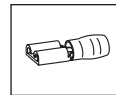

Caracteristici

- Izolatie sintetica: poliamida / PVC (varianta cu X in cod)
- Codificare pe culori dupa normele in vigoare

Material

- Cu-ETP

Suprafata

- Stanata

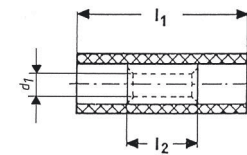

Sectiune mm <sup>2</sup>	Cod	Culoare	Dimensiune mm			Greutate/ 100 buc. ~ kg	buc/pac
			d1	l1	l2		
0.1-0.4	669	■	1.2	20	12	0.030	100
0.5-1	670	■	1.6	25	15	0.090	100
1.5-2.5	680	■	2.3	25	15	0.115	100
4-6	700	■	3.6	27	15	0.250	100

■ Mufa cupru cu izolatie termo 0.5 - 6 mm<sup>2</sup>

- Cu izolatie termocontractibila, impermeabila
- Pentru conductoare multifilare fine si extrafine

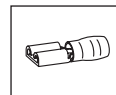

Caracteristici

- Izolatie sintetica: PE
- Codificare pe culori dupa normele in vigoare

Material

- Cu-ETP

Suprafata

- Stanata

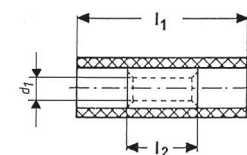

Sectiune mm <sup>2</sup>	Cod	Culoare	Dimensiune mm			Greutate/ 100 buc. ~ kg	buc/cutie
			d1	l1	l2		
0.5-1	670WS	■	1.6	36	15	0.12	100
1.5-2.5	680WS	■	2.3	36	15	0.15	100
4-6	700WS	■	3.4	41	15	0.25	100